

| REVISIONS |             |       |          |
|-----------|-------------|-------|----------|
| REV #     | DESCRIPTION | APPV. | REV DATE |
|           |             |       |          |
|           |             |       |          |

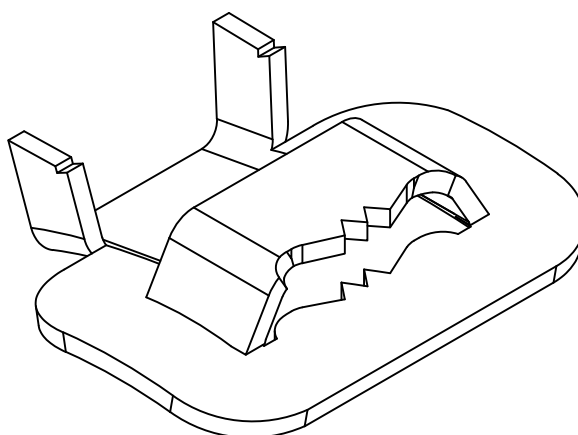

**JAW TYPE BUCKLE SUITABLE FOR 20 x 0.7 mm THICK SS STRAP**

**MATERIAL : STAINLESS STEEL (SS304)**

**TOLERANCE: ± 5% FOR ALL DIMENSIONS**

**NOTE :**

- 1) UNLESS OTHERWISE SPECIFIED ALL DIMENSIONS ARE IN mm
- 2) MATERIAL : AS SPECIFIED
- 3) FINISH : NATURAL & DEGREASED
- 4) THIS DRAWING IS A SUBSIDAIRY DRAWING FOR 949#2-2004



AXIS ELECTRICAL COMPONENTS (I) P. LTD.  
MUMBAI - 400067. INDIA.  
TEL : 91-22-67756000  
e-mail:marketing@axis-india.com

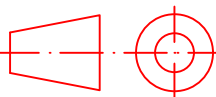

**MATERIAL :**

**REF NOTE**

**DRAWN :** VS

**CHECKED :** AG

**APPROVED :** NT

**ISSUE DT :** 23/12/2005

**SCALE :** DO NOT SCALE.

**DRG No :** 949#2-2004-2

**C**

**TITLE :**

**JAW TYPE BUCKLE FOR  
20 x 0.7mm STRAP**